

Explosion-protected  
Linear LED Light Fitting for Zone 1 and 21

CEAG Products

# eLLK/M 92 LED 400/800

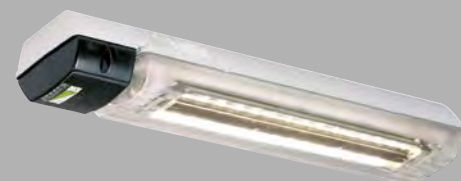
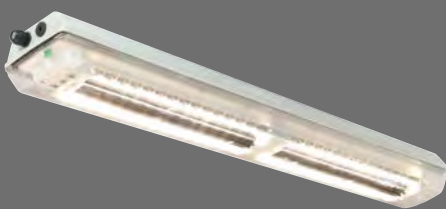

**Crouse-Hinds**  
by **EAT•N**

# Ex-linear LED light fittings

eLLK/M 92 LED 400/800 / eLLK/M 92 LED 400/800 CG-S/NIB  
(Zone 1, 2, 21, 22)

## The efficient solution for your explosion-protected lighting concept

The explosion-protected linear light fittings series eLLK / M 92 LED 400/800 combines the latest LED technology with the protection of a reliable housing solution. As a result, this light fitting series is the ideal solution for lighting tasks in harsh and hazardous environments.

## Latest lighting technology for a proven lighting concept

As a leading manufacturer of explosion-protected luminaires, we have designed a revolutionary LED module to fit into the existing eLLK/M 92018/18 and

eLLK/M 92036/36. The linear LED module can also be used for converting existing eLLK/M 92 light fittings with fluorescent lamps and an electronic ballast electronic ballast (EVG 09) into LED linear light fittings in just few simple steps. A special designed reflector system directs the light output of the high power LEDs to the working area without any multi-shadowing or light pollution.

The LED system design and certification allow the use in the tried and tested Ex e technology of the eLLK/M 92 light fittings. With the use of our electronic ballast EVG 09 as the driver, we can rely on more than 20 years successful operation in harsh and hazardous environments.

## The advantages of the LED module:

- Environmentally friendly, no mercury
- Shock and vibration resistant, no filament or glass to break
- Immediate start, instant full illumination
- No life time reduction due to switching cycles
- Reduced disposal costs

## Energy and cost savings

- 20% energy savings compared to fluorescent lamps
- Additional energy savings due to operation on demand (night/day and presence-mode)
- Reduced maintenance costs compared to standard fluorescent lamps
- Lower overall cost of ownership

## Operating life

- The expected operating life of a Cooper Crouse-Hinds LED module is 60,000 hours. This is a significant improvement compared to traditional light sources.
- Heat sinks are specifically engineered to remove heat from the LEDs to ensure a longer life, better lumen output and accurate colour temperature.
- Fully operational with CG-S modules for connection to CEAG central battery emergency lighting systems.

## Easy and cost-effective installation

Like all the luminaires in the eLLK lighting family, our standard LED linear luminaires feature a single-ended through-wiring, which, in conjunction with the generously dimensioned terminal compartment, allows a cost-effective installation. The double-sided locking facility with 10 or 20 latch points allows the protective bowl to be hinged on both sides, meaning that the fitting can be mounted on either side.

## International certification

Special versions according to the NEC standards are available for the use on the American market.

## Features

- 20 % energy savings compared to similar fluorescent luminaires
- Special reflector design with indirect light distribution prevents undue glare and multi-shadowing
- Tried and tested technology; the EVG 09 has been used as a driver for more than 20 years
- Various light colours available- 4000 K / 5600 K
- Selected LED chips with perfect binning, low power loss and long life
- Ex-e technology for easy maintenance
- For ambient temperatures from -25 °C up to +45 °C / +55°C (HT)
- Special version to NEC standards (CSA)



## Ordering details



Type	Version	Terminals	Through-wiring single-ended	Through-wiring twin-ended	Cable gland/thread	Threaded plug	Blanking plug	Order No.
<b>eLLK 92 LED 400</b>								
eLLK 92 LED 400	1/6-1K	1 x 6	x	–	2 x M25, plastic		1	<b>1 2265 500 101</b>
eLLK 92 LED 400	2/6-2K	2 x 6	–	x	2 x M25, plastic	2 x M25		<b>1 2265 500 103</b>
eLLK 92 LED 400	1/6-1M <sup>1)</sup>	1 x 6	x	–	2 x M20, metal thread	1 x M20		<b>1 2265 500 109</b>
eLLK 92 LED 400	2/6-2M <sup>1)</sup>	2 x 6	–	x	4 x M20, metal thread	2 x M20		<b>1 2265 500 111</b>
eLLK 92 LED 400 <b>CSA</b>	1/6- NPT	1 x 6	x	–	2 x M25 - 3/4" Myers hub	2 x M25		<b>1 2265 500 309</b>
eLLK 92 LED 400 <b>CSA</b>	1/6- NPT	1 x 6	x	–	2 x M25 - 1/2" Myers hub	2 x M25		<b>1 2265 500 310</b>
eLLK 92 LED 400 <b>CSA</b>	2/6- NPT	2 x 6	–	x	2 x M25 - 3/4" Myers hub	2 x M25		<b>1 2265 500 311</b>



<b>eLLK 92 LED 800</b>								
eLLK 92 LED 800	1/6-1K	1 x 6	x	–	2 x M25, plastic		1	<b>1 2266 500 101</b>
eLLK 92 LED 800	2/6-2K	2 x 6	–	x	2 x M25, plastic	2 x M25		<b>1 2266 500 103</b>
eLLK 92 LED 800	1/6-1M <sup>1)</sup>	1 x 6	x	–	2 x M20, metal thread	1 x M20		<b>1 2266 500 109</b>
eLLK 92 LED 800	2/6-2M <sup>1)</sup>	2 x 6	–	x	4 x M20, metal thread	2 x M20		<b>1 2266 500 111</b>
eLLK 92 LED 800 <b>CSA</b>	1/6- NPT	1 x 6	x	–	2 x M25 - 3/4" Myer hub	2 x M25		<b>1 2266 500 309</b>
eLLK 92 LED 800 <b>CSA</b>	1/6- NPT	1 x 6	x	–	2 x M25 - 1/2" Myer hub	2 x M25		<b>1 2266 500 310</b>
eLLK 92 LED 800 <b>CSA</b>	2/6- NPT	2 x 6	–	x	2 x M25 - 3/4" Myer hub	2 x M25		<b>1 2266 500 311</b>



<b>eLLM 92 LED</b>								
eLLM 92 LED 400	1/3-1K	1 x 3	–	–	1 x M25, plastic			<b>1 2268 500 101</b>
eLLM 92 LED 800	1/3-1K	1 x 3	–	–	1 x M25, plastic			<b>1 2269 500 101</b>



<b>eLLK 92 LED 400 CG-S <sup>2)</sup></b>								
eLLK 92 LED 400 CG-S	2/6-2K	2 x 6	–	x	2 x M25, plastic	2 x M25		<b>1 2265 510 103</b>
eLLK 92 LED 400 CG-S	2/6-2M <sup>1)</sup>	2 x 6	–	x	4 x M20, metal thread	2 x M25		<b>1 2265 510 111</b>



<b>eLLK 92 LED 800 CG-S <sup>2)</sup></b>								
eLLK 92 LED 800 CG-S	2/6-2K	2 x 6	–	x	2 x M25, plastic	2 x M25		<b>1 2266 510 103</b>
eLLK 92 LED 800 CG-S	2/6-2M <sup>1)</sup>	2 x 6	–	x	4 x M20, metal thread	2 x M25		<b>1 2266 510 111</b>

Type	Version	Terminals	Through-wiring single-ended	Through-wiring twin-ended	Cable gland/thread	Threaded plug	Blanking plug	Order No. 110-127 V AC	Order No. 220-254 V AC
------	---------	-----------	-----------------------------	---------------------------	--------------------	---------------	---------------	------------------------	------------------------



<b>eLLK 92 LED 400 NIB <sup>3)</sup></b>									
eLLK 92 LED 400 NIB	1/6-1K	1 x 6	x	–	2 x M25, plastic		1	<b>1 2260 579 401</b>	<b>1 2260 579 101</b>
eLLK 92 LED 400 NIB	2/6-2K	2 x 6	–	x	2 x M25, plastic	2 x M25		<b>1 2260 579 403</b>	<b>1 2260 579 103</b>
eLLK 92 LED 400 NIB	1/6-1M <sup>1)</sup>	1 x 6	x	–	2 x M20, metal thread	1 x M20		<b>1 2260 579 409</b>	<b>1 2260 579 109</b>
eLLK 92 LED 400 NIB	2/6-2M <sup>1)</sup>	2 x 6	–	x	4 x M20, metal thread	2 x M20		<b>1 2260 579 411</b>	<b>1 2260 579 111</b>
eLLK 92 LED 400 NIB <b>CSA</b>	2/6-2 NPT	2 x 6	–	x	2 x M25 - 3/4" Myers hub	2 x M25		<b>1 2260 579 333</b>	<b>1 2260 579 311</b>



<b>eLLK 92 LED 800 NIB <sup>3)</sup></b>									
eLLK 92 LED 800 NIB	1/6-1K	1 x 6	x	–	2 x M25, plastic		1	<b>1 2261 579 401</b>	<b>1 2261 579 101</b>
eLLK 92 LED 800 NIB	2/6-2K	2 x 6	–	x	2 x M25, plastic	2 x M25		<b>1 2261 579 403</b>	<b>1 2261 579 103</b>
eLLK 92 LED 800 NIB	1/6-1M <sup>1)</sup>	1 x 6	x	–	2 x M20, metal thread	1 x M20		<b>1 2261 579 409</b>	<b>1 2261 579 109</b>
eLLK 92 LED 800 NIB <b>CSA</b>	2/6-2 NPT	2 x 6	–	x	2 x M25 - 3/4" Myers hub	2 x M25		<b>1 2261 579 333</b>	<b>1 2261 579 311</b>



<b>eLLM 92 LED 400 NIB <sup>3)</sup></b>									
eLLM 92 LED 400 NIB	1/3-1K	1 x 6	–	–	2 x M25, plastic			<b>1 2273 569 101</b>	

Scope of delivery including LED-module, without fixing material

Metal cable glands see catalogue part 2: 2.3.12 ff

<sup>1)</sup> with metal thread, without cable gland

<sup>2)</sup> for operation with CEAG-emergency supply system







<sup>3)</sup> Self-contained emergency light fitting



# Ordering details

eLLK/M 92 LED 400/800

## Ordering details

Type	Version	Terminals	Through-wiring single-ended	Through-wiring twin-ended	Cable gland/thread	Threaded plug	Blanking plug	Order No.	
<b>eLLK 92 LED 400 with 5600 K light colour</b>									
	eLLK 92 LED 400	1/6-1M <sup>1)</sup> 1 x 6	x	–	2 x M20, metal thread	1 x M20		<b>1 2265 502 109</b>	
	eLLK 92 LED 400	2/6-2M <sup>1)</sup> 2 x 6	–	x	4 x M20, metal thread	2 x M20		<b>1 2265 502 111</b>	
<b>eLLK 92 LED 800 with 5600 K light colour</b>									
	eLLK 92 LED 800	1/6-1M <sup>1)</sup> 1 x 6	x	–	2 x M20, metal thread	1 x M20		<b>1 2266 502 109</b>	
	eLLK 92 LED 800	2/6-2M <sup>1)</sup> 2 x 6	–	x	4 x M20, metal thread	2 x M20		<b>1 2266 502 111</b>	
<b>eLLK 92 LED 400 CG-S with 5600 K light colour <sup>2)</sup></b>									
	eLLK 92 LED 400 CG-S	2/6-2M <sup>1)</sup> 2 x 6	–	x	4 x M20, metal thread	2 x M25		<b>1 2265 512 111</b>	
<b>eLLK 92 LED 800 CG-S with 5600 K light colour <sup>2)</sup></b>									
	eLLK 92 LED 800 CG-S	2/6-2M <sup>1)</sup> 2 x 6	–	x	4 x M20, metal thread	2 x M25		<b>1 2266 512 111</b>	
Type	Version	Terminals	Through-wiring single-ended	Through-wiring twin-ended	Cable gland/thread	Threaded plug	Blanking plug	Order No. for 110-127 V AC	Order No. for 220-254 V AC
<b>eLLK 92 LED 400 NIB with 5600 °K light colour <sup>3)</sup></b>									
	eLLK 92 LED 400 NIB	1/6-1M <sup>1)</sup> 1 x 6	x	–	2 x M20, metal thread	1 x M20		<b>1 2260 580 409</b>	<b>1 2260 580 109</b>
	eLLK 92 LED 400 NIB	2/6-2M <sup>1)</sup> 2 x 6	–	x	4 x M20, metal thread	2 x M20		<b>1 2260 580 411</b>	<b>1 2260 580 111</b>
<b>eLLK 92 LED 800 NIB with 5600 °K light colour <sup>3)</sup></b>									
	eLLK 92 LED 800 NIB	1/6-1M <sup>1)</sup> 1 x 6	x	–	2 x M20, metal thread	1 x M20		<b>1 2261 580 409</b>	<b>1 2261 580 109</b>
	eLLK 92 LED 800 NIB	2/6-2M <sup>1)</sup> 2 x 6	–	x	4 x M20, metal thread	2 x M20		<b>1 2261 580 411</b>	<b>1 2261 580 111</b>
Type	Version	Terminals	Through-wiring single-ended	Through-wiring twin-ended	Cable gland/thread	Threaded plug	Blanking plug	Order No.	
<b>eLLK 92 LED 400 HT for Ta ≤ +55 °C</b>									
	eLLK 92 LED 400 HT	1/6-1K 1 x 6	x	–	2 x M25, plastic		1	<b>1 2265 550 101</b>	
	eLLK 92 LED 400 HT	2/6-2K 2 x 6	–	x	2 x M25, plastic	2 x M25		<b>1 2265 550 103</b>	
	eLLK 92 LED 400 HT	1/6-1M <sup>1)</sup> 1 x 6	x	–	2 x M20, metal thread	1 x M20		<b>1 2265 550 109</b>	
	eLLK 92 LED 400 HT	2/6-2M <sup>1)</sup> 2 x 6	–	x	4 x M20, metal thread	2 x M20		<b>1 2265 550 111</b>	
<b>eLLK 92 LED 800 HT for Ta ≤ +55 °C</b>									
	eLLK 92 LED 800 HT	1/6-1K 1 x 6	x	–	2 x M25, plastic		1	<b>1 2266 550 101</b>	
	eLLK 92 LED 800 HT	2/6-2K 2 x 6	–	x	2 x M25, plastic	2 x M25		<b>1 2266 550 103</b>	
	eLLK 92 LED 800 HT	1/6-1M <sup>1)</sup> 1 x 6	x	–	2 x M20, metal thread	1 x M20		<b>1 2266 550 109</b>	
	eLLK 92 LED 800 HT	2/6-2M <sup>1)</sup> 2 x 6	–	x	4 x M20, metal thread	2 x M20		<b>1 2266 550 111</b>	
Type	Version	Terminals	Through-wiring single-ended	Through-wiring twin-ended	Cable gland/thread	Threaded plug	Blanking plug	Order No. for 110-127 V AC	Order No. for 220-254 V AC
<b>eLLK 92 LED 800 NIB HT for Ta ≤ +55 °C</b>									
	eLLK 92 LED 800 NIB HT	1/6-1K 1 x 6	x	–	2 x M25, plastic		1	<b>1 2261 581 401</b>	<b>1 2261 581 101</b>
	eLLK 92 LED 800 NIB HT	2/6-2K 2 x 6	–	x	2 x M25, plastic	2 x M25		<b>1 2261 581 403</b>	<b>1 2261 581 103</b>
	eLLK 92 LED 800 NIB HT	1/6-1M <sup>1)</sup> 1 x 6	x	–	2 x M20, metal thread	1 x M20		<b>1 2261 581 409</b>	<b>1 2261 581 109</b>
	eLLK 92 LED 800 NIB HT	2/6-2M <sup>1)</sup> 2 x 6	–	x	4 x M20, metal thread	2 x M20		<b>1 2261 581 411</b>	<b>1 2261 581 111</b>

Scope of delivery including LED-module, without fixing material  
Metal cable glands see catalogue part 2: 2.3.12 ff  
<sup>1)</sup> with metal thread, without cable gland  
<sup>2)</sup> for operation with CEAG-emergency supply system  
<sup>3)</sup> Self-contained emergency light fitting

## Accessories

Type	Order No.
Battery set Type 2710-3 with LED display and microprocessor-monitoring, complete	<b>2 2710 904 000</b>
Single sided through wiring 2/6 with 2 entries M25, incl. terminals and mounting material for eLLM 92 LED 400/800	<b>2 2218 602 000</b>



**Polar curve eLLK/M 92 LED 400 <sup>1)</sup>**

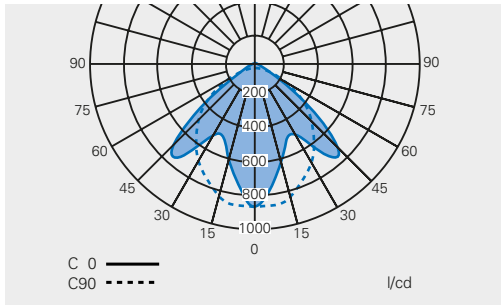

**Polar curve eLLK/M 92 LED 800 CG-S in emergency operation <sup>1)</sup>**

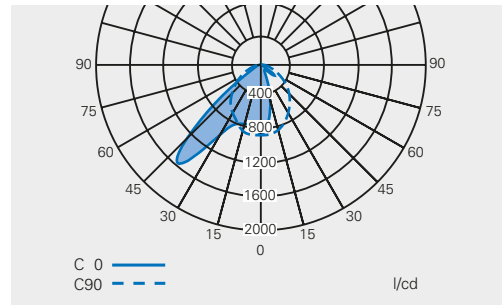

**Polar curve eLLK/M 92 LED 800 <sup>1)</sup>**

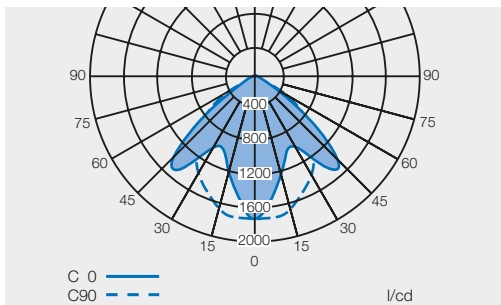

**Polar curve eLLK/M 92 LED 400 NIB in emergency operation <sup>1)</sup>**

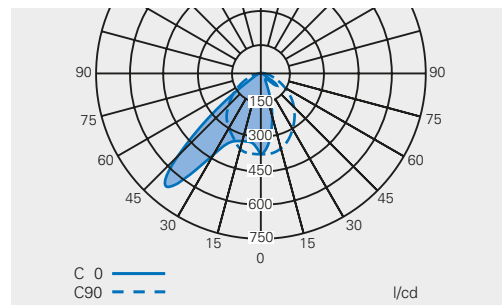

**Polar curve eLLK/M 92 LED 400 CG-S in emergency operation <sup>1)</sup>**

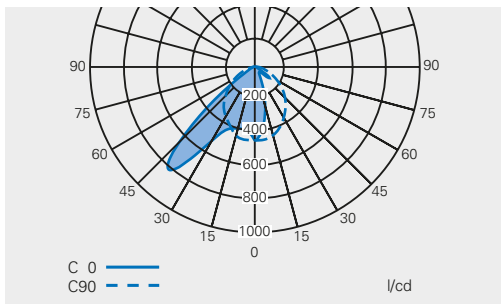

**Polar curve eLLK/M 92 LED 800 NIB in emergency operation <sup>1)</sup>**

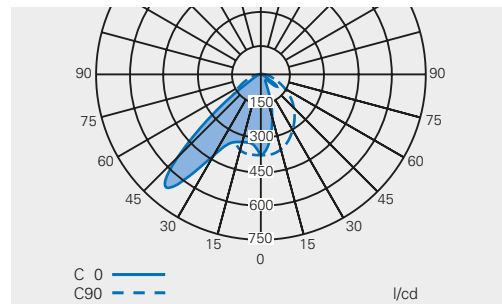

1 ) reduced light output for eLLK 92 LED .... HT: approx 15 %

**eLLK 92 LED 400/800**

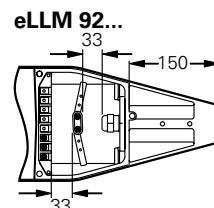
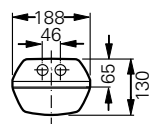
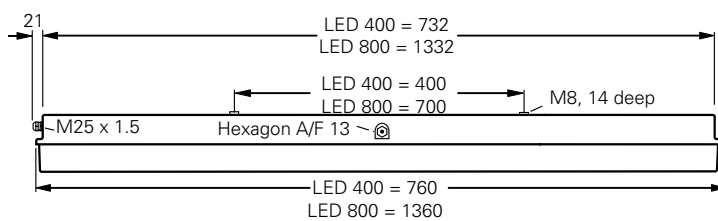

**Version 1/3**

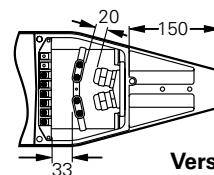
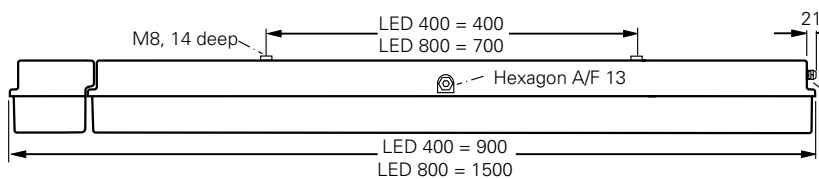

**Version 2/6**

**eLLM 92 LED 400/800**

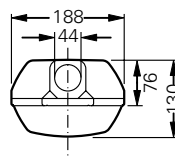
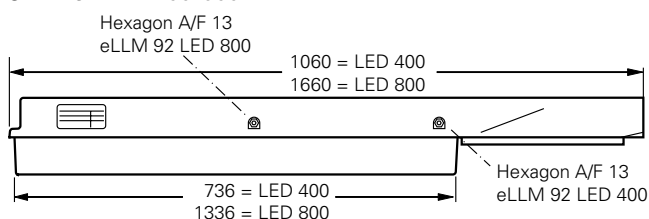

Dimensions in mm

# Technical data

eLLK 92 LED 400 (HT)/ eLLK 92 LED 800 (HT)



## Technical data

	eLLK/M 92 LED 400 / eLLK 92 LED 400 HT	eLLK/M 92 LED 800 / eLLK 92 LED 800 HT
EC-Type Examination Certificate	BVS 09 ATEX E 034	BVS 09 ATEX E 034
IECEX Certificate of Conformity	IECEX BVS 09.0033	IECEX BVS 09.0033
Marking accd. to 94/9/EC	⊕ II 2 G Ex de IIC T4 Gb ⊕ II 2 D Ex tb IIIC T80 °C Db IP66	⊕ II 2 G Ex de IIC T4 Gb ⊕ II 2 D Ex tb IIIC T80 °C Db IP66
Marking accd. to IECEx	Ex de IIC T4 Gb Ex tb IIIC T80 °C Db	Ex de IIC T4 Gb Ex tb IIIC T80 °C Db
Permissible ambient temperature	-25 °C up to +45 °C / -25 °C up to +55 °C (HT)	-25 °C up to +45 °C / -25 °C up to +55 °C (HT)
IK-class according to EN 50102	IK 10 $\Delta$ 20 J	IK 10 $\Delta$ 20 J
Rated voltage	110 V - 254 V AC 110 V - 250 V DC	110 V - 254 V AC 110 V - 250 V DC
Rated current	0,15 A / 0,11 A (HT)	0,25 A / 0,19 A (HT)
Frequency	50 - 60 Hz	50 - 60 Hz
Life expectancy LED module	L 70 = 60.000 h at Ta = 25 °C	L 70 = 60.000 h at Ta = 25 °C
Power factor cos	$\geq 0.95$	$\geq 0.95$
Circuit	EVG	EVG
Protection class	I	I
Illuminance at measurement plane	comparable with luminaires for fluorescent lamps	comparable with luminaires for fluorescent lamps
CRI	> 80	> 80
Lamp / Illuminant	LED module 400 - 2 x 13 W / LED module 400 HT - 2 x 11 W	LED module 800 - 2 x 26 W / LED module 800 HT - 2 x 22 W
Light colour	4000 K, 5600 K (option)	4000 K, 5600 K (option)
Dimensions (L x W x H)	760 x 188 x 130 mm	1360 x 188 x 130 mm
Connecting terminals	L1, L2, L3, L, N, PE; max. 2 x 6 mm <sup>2</sup> per terminal	L1, L2, L3, L, N, PE; max. 2 x 6 mm <sup>2</sup> per terminal
Enclosure colour	RAL 7035 light grey	RAL 7035 light grey
Enclosure material	glass-fibre reinforced polyester	glass-fibre reinforced polyester
Weight	6.9 kg	10.7 kg
Cable glands / gland plates / enclosure drilling	Ex-e cable glands M25 x 1.5 (plastic) for cables from $\varnothing$ 8 - 17 mm, option: M20 x 1.5 metal thread <sup>1)</sup>	Ex-e cable glands M25 x 1.5 (plastic) for cables from $\varnothing$ 8 - 17 mm, option: M20 x 1.5 metal thread <sup>1)</sup>
Degree of protection accd. to EN 60529	IP66	IP66
Protective cover / protective bowl	Polycarbonate	Polycarbonate

<sup>1)</sup> with dustcover if entry/thread is not closed



### Technical data

	eLLK 92 LED 400 CG-S	eLLK 92 LED 800 CG-S
EC-Tye Examination Certificate	BVS 09 ATEX E 034	BVS 09 ATEX E 034
IECEX Certificate of Conformity	IECEX BVS 09.0033	IECEX BVS 09.0033
Marking to 94/9/EC	⊕ II 2 G Ex de IIC T4 Gb ⊕ II 2 D Ex tb IIIC T80 °C Db IP66	⊕ II 2 G Ex de IIC T4 Gb ⊕ II 2 D Ex tb IIIC T80 °C Db IP66
Marking to IECEx	Ex de IIC T4 Gb Ex tb IIIC T80 °C Db	Ex de IIC T4 Gb Ex tb IIIC T80 °C Db
Permissible ambient temperature	-25 °C up to +45 °C	-25 °C up to +45 °C
IK-class according to EN 50102	IK 10 ± 20 J	IK 10 ± 20 J
Rated voltage	220 V - 254 V AC 195 V - 250 V DC	220 V - 254 V AC 195 V - 250 V DC
Rated current	0.15 A	0.25 A
Frequency	50 - 60 Hz	50 - 60 Hz
Lifetime LED module	L 70 = 60.000 h at Ta = 25 °C	L 70 = 60.000 h at Ta = 25 °C
Power factor cos	≥ 0.95	≥ 0.95
Circuit	EVG/CG-S	EVG/CG-S
Insulation class	I	I
Illuminance at measurement plane	comparable with luminaires for fluorescent lamps	comparable with luminaires for fluorescent lamps
CRI	> 80	> 80
Lamp/Illuminant	LED module 400 - 2 x 13 W	LED module 800 - 2 x 26 W
Light colour	4000 K, 5600 K (option)	4000 K, 5600 K (option)
Dimensions (L x W x H)	760 x 188 x 130 mm	1360 x 188 x 130 mm
Connecting terminals	L1, L2, L3, L, N, PE; max. 2 x 6 mm <sup>2</sup> per terminal	L1, L2, L3, L, N, PE; max. 2 x 6 mm <sup>2</sup> per terminal
Enclosure colour	RAL 7035 light grey	RAL 7035 light grey
Enclosure material	glass-fibre reinforced polyester	glass-fibre reinforced polyester
Weight	7.4 kg	11.1 kg
Cable glands / Gland plates / Enclosure drilling	Ex-e cable glands M25 x 1.5 (plastic) for cables from Ø 8 - 17 mm, option: M20 x 1.5 metal thread <sup>1)</sup>	Ex-e cable glands M25 x 1.5 (plastic) for cables from Ø 8 - 17 mm, option: M20 x 1.5 metal thread <sup>1)</sup>
Degree of protection accd. EN 60529	IP66	IP66
Protective cover / protective bowl	Polycarbonate	Polycarbonate

# Technical data

eLLK 92 LED 400 NIB / eLLK 92 LED 800 NIB



## Technical data

	eLLK 92 LED 400 NIB	eLLK 92 LED 800 NIB / eLLK 92 LED 800 NIB HT
EC-Tye Examination Certificate	BVS 09 ATEX E 034	BVS 09 ATEX E 034
IECEX-Certification of conformity	IECEX BVS 09.0033	IECEX BVS 09.0033
Marking to 94/9/EC	⊕ II 2 G Ex de mb ib IIC T4 Gb ⊕ II 2 D Ex tb IIIC T80 °C Db IP66	⊕ II 2 G Ex de mb ib IIC T4 Gb ⊕ II 2 D Ex tb IIIC T80 °C Db IP66
Marking to IECEX	Ex de mb ib IIC T4 Gb Ex tb IIIC T80 °C Db	Ex de mb ib IIC T4 Gb Ex tb IIIC T80 °C Db
Permissible ambient temperature	-25 °C up to +45 °C / specified data -5 °C up to +35 °C	-25 °C up to +45 °C / -25 °C up to +55 °C specified data -5 °C up to +35 °C
IK-class according to EN 50102	IK 10 $\Delta$ 20 J	IK 10 $\Delta$ 20 J
Battery	Battery set with 7 Ah-NC battery, with LED display and monitoring via microprocessor	Battery set with 7 Ah-NC battery, with LED display and monitoring via microprocessor
Rated voltage	220 V - 254 V AC 110 V - 127 V AC (option)	220 V - 254 V AC 110 V - 127 V AC option
Rated current	0.2 A	0.31 A / 0,25 A
Frequency	50 - 60 Hz	50 - 60 Hz
Ladezeit	$\geq$ 14 h	$\geq$ 14 h
Lifetime LED module	L 70 = 60.000 h at ta=25 °C	L 70 = 60.000 h at ta=25 °C
Power factor cos	$\geq$ 0.95	$\geq$ 0.95
Circuit	EVG with emergency lighting supply	EVG with emergency lighting supply
Insulation class	I	I
Illuminance at measurement plane	equivalent to related fluorescent tubes	equivalent to related fluorescent tubes
CRI	> 80	> 80
Lamp/Illuminant	LED module 400 - 2 x 13 W	LED module 800 - 2 x 26 W / LED module 800 HT - 2 x 22 W
Light colour	4000 K, 5600 K (option)	4000 K, 5600 K (option)
Rated emergency operating time	2.4 h	3.5 h
luminous flux relation emergency-mains operation (one LED line)	98.5 %	44.1 %
Dimensions (L x W x H)	900 x 188 x 130 mm	1500 x 188 x 130 mm
Connecting terminals	L1, L2, L3, L, N, PE; max. 2 x 6 mm <sup>2</sup> per terminal	L1, L2, L3, L, N, PE; max. 2 x 6 mm <sup>2</sup> per terminal
Enclosure colour	RAL 7035 light grey	RAL 7035 light grey
Enclosure material	Glass fibre reinforced polyester	Glass fibre reinforced polyester
Weight	10.5 kg	15.3 kg
Cable glands / Gland plates / Enclosure drilling	Ex-e-cable glands M25 x 1,5 (plastic) for cables $\varnothing$ 8 - 17 mm, Option: M20 x 1,5 metal thread <sup>1)</sup>	Ex-e-cable glands M25 x 1,5 (plastic) for cables $\varnothing$ 8 - 17 mm, Option: M20 x 1,5 metal thread <sup>1)</sup>
Degree of protection accd. EN 60529	IP66	IP66
Protective cover / protective bowl	Polycarbonate	Polycarbonate

<sup>1)</sup> With dustcover if entry/thread is not closed





### Technical data

	eLLK 92 LED 400 / eLLK 92 LED 800	eLLK 92 LED 400 NIB / eLLK 92 LED 800 NIB
Marking accd. to NEC 505/CEC 018	Class I, Zone 1, AEx de mb IIC T4 Gb / Ex de mb IIC T4 Gb Zone 21, AEx tb IIIC T80°C Db/ Ex tb IIIC T80°C Db	Class I, Zone 1, AEx de mb ib IIC T4 Gb / Ex de mb ib IIC T4 Gb Zone 21, AEx tb IIIC T80°C Db/ Ex tb IIIC T80°C Db
Marking accd. to NEC 500	Class I, Division 2, Groups A, B, C, D T4. Class II, Division 1, Groups E, F and G.	Class I, Division 2, Groups A, B, C, D T4. Class II, Division 1, Groups E, F and G.
Certificate of Compliance	CSA 14.700 11905	CSA 14.700 11905
Permissible ambient temperature	-25 °C up to +45 °C	-25 °C up to +45 °C specified data -5 °C up to +35 °C
IK-class according to EN 50102	IK 10 $\pm$ 20 J	IK 10 $\pm$ 20 J
Battery		Battery set with 7 Ah-NC battery, with LED display and monitoring via microprocessor
Rated voltage	110 V - 254 V AC 110 V - 250 V DC	220 V - 254 V AC (type U240) 110 V - 127 V AC (type U120)
Rated current	0.15 A / 0.25 A	0.2 A / 0.31 A
Frequency	50 - 60 Hz	50 - 60 Hz
Charging duration		$\geq$ 14 h
Lifetime LED module	L 70 = 60.000 h at ta=25 °C	L 70 = 60.000 h at ta=25 °C
Power factor cos	$\geq$ 0.95	$\geq$ 0.95
Circuit	EVG	EVG with emergency lighting supply
Insulation class	I	I
Illuminance at measurement plane	equivalent to related fluorescent tubes	equivalent to related fluorescent tubes
CRI	> 80	> 80
Lamp/Illuminant	LED module 400 - 2 x 13 W / LED module 800 - 2 x 26 W	LED module 400 - 2 x 13 W / LED module 800 - 2 x 26 W
Light colour	4000 K, 5600 K (option)	4000 K, 5600 K (option)
Rated emergency operating time		2.4 h / 3.5 h
Luminous flux relation emergency-mains operation (one LED line)		98.5 % / 44.1 %
Dimensions (L x W x H)	760 x 188 x 130 mm / 1360 x 188 x 130 mm	900 x 188 x 130 mm / 1500 x 188 x 130 mm
Connecting terminals	L1, L2, L3, L, N, PE; max. 2 x 6 mm <sup>2</sup> per terminal	L1, L2, L3, L, N, PE; max. 2 x 6 mm <sup>2</sup> per terminal
Enclosure colour	RAL 7035 light grey	RAL 7035 light grey
Enclosure material	Glass fibre reinforced polyester	Glass fibre reinforced polyester
Weight	6.9 kg / 10.7 kg	10.5 kg / 15.3 kg
Cable glands / Gland plates / Enclosure drilling	1/2 " or 3/4" NPT Myers hub metal thread with dustcover	1/2 " or 3/4" NPT Myers hub metal thread with dustcover
Degree of protection accd.	EN 60529 : IP66 / NEMA: 4X	EN 60529 : IP66 / NEMA: 4X
Protective cover / protective bowl	Polycarbonate	Polycarbonate





Eaton's Crouse-Hinds Business

# The safety you rely on.

See the complete offering of Hazardous and Industrial Products at [www.crouse-hinds.de](http://www.crouse-hinds.de).

**U.S. (Global Headquarters):  
Eaton's Crouse-Hinds  
Business**

1201 Wolf Street  
Syracuse, NY 13208

(866) 764-5454  
FAX: (315) 477-5179  
FAX Orders Only:  
(866) 653-0640

[crouse.customerctr@  
cooperindustries.com](mailto:crouse.customerctr@cooperindustries.com)

**For more information:**

If further assistance is required, please contact an authorized Eaton Distributor, Sales Office, or Customer Service Department.

**Australia**

Phone +61-2-8787-2777  
Fax +61-2-9609-2342  
CEASales@  
cooperindustries.com

**China**

Phone +86-21-2899-3600  
Fax +86-21-2899-4055  
cchsals@cooperindustries.com

**Great Britain**

Phone +44-247-630-89 30  
Fax +44-247-630-10 27  
sales.CCH.gb@  
cooperindustries.com

**India**

Phone +91-124-4683888  
Fax +91-124-4683899  
cchindia@cooperindustries.com

**Canada**

Toll Free +1-800-265-0502  
Fax +1-800-263-9504  
Fax orders only:  
+1-866-653-0645

**Korea**

Phone +82-2-3484-6783  
Fax +82-2-3484-6778  
CCHK-sales@  
cooperindustries.com

**Mexico/Latin America/  
Caribbean**

Phone +52-555-804-4000  
Fax +52-555-804-4020  
mxmercadotecnia@  
cooperindustries.com

**Spain**

Phone +34-9-37362710  
Fax +34-9-37835055  
sales.CCH.es@  
cooperindustries.com

**Middle East (Dubai)**

Phone +971-4-427-2522 / 2500  
Fax +971-4-429-8521  
sales.CCH.me@  
cooperindustries.com

**The Netherlands**

Phone +31-10-2452145  
Fax +31-10-2452121  
sales.CCH.nl@  
cooperindustries.com

**Norway**

Phone +47-32-244600  
Fax +47-32-244646  
sales.CCH.no@  
cooperindustries.com

**Singapore:**

Phone +65-6645-9888  
Fax +65-6297-4819  
chsi-sales@  
cooperindustries.com

**Turkey**

Phone +90-216-464-20-20  
Fax +90-216-464-20-10  
infoEGTurkey@eaton.com

**Russia**

Phone +7-495 510-24-27  
Fax +7-495 510-24-28  
info@cooper.ru.com  
[www.cooper-russia.ru](http://www.cooper-russia.ru)

**Eaton's Crouse-Hinds Business**

Neuer Weg – Nord 49  
D-69412 Eberbach

Phone +49 (0) 6271/806-500  
Fax +49 (0) 6271/806-476  
E-mail [info-ex@eaton.com](mailto:info-ex@eaton.com)  
Internet [www.crouse-hinds.de](http://www.crouse-hinds.de)

**Eaton**

1000 Eaton Boulevard  
Cleveland, OH 44122  
United States  
[Eaton.com](http://Eaton.com)

© 2014 Eaton Corporation  
All Rights Reserved  
Printed in USA  
Publication No. BR ...  
February 2015

Changes to the products, to the information contained in this document, and to prices are reserved; so are errors and omissions. Only order confirmations and technical documentation by Eaton is binding. Photos and pictures also do not warrant a specific layout or functionality. Their use in whatever form is subject to prior approval by Eaton. The same applies to Trademarks (especially Eaton, Moeller, and Cutler-Hammer). The Terms and Conditions of Eaton apply, as referenced on Eaton Internet pages and Eaton order confirmations.

**Eaton's Crouse-Hinds Business**

1201 Wolf Street  
Syracuse, NY 13208  
(866) 764-5454  
[crouse.customerctr@cooperindustries.com](mailto:crouse.customerctr@cooperindustries.com)

Eaton is a registered trademark.

All other trademarks are property of their respective owners.

**Crouse-Hinds**  
by **EATON**